

# REPLACEMENT PARTS SUITABLE FOR Hypertherm®

HPR®130/HPR®260  
Torches and Cable leads

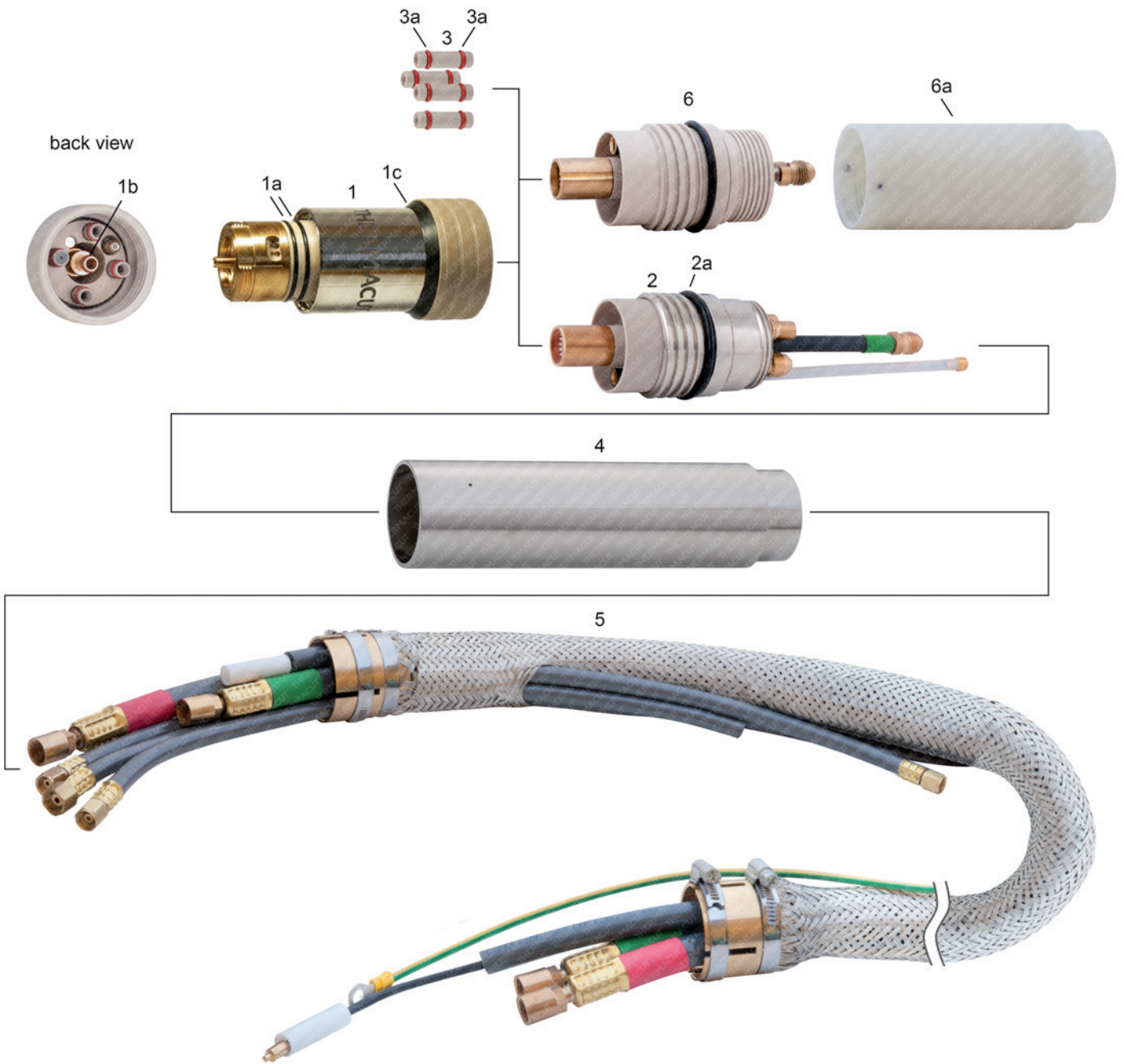

Last update of this page: 15/02/2018. See Revision history for details.

**THERMACUT®**  
THE CUTTING COMPANY

WWW.THERMACUT.CZ  
TEL.: +420 556 423 418  
SALES@THERMACUT.CZ

WWW.THERMACUT.DE  
TEL.: +49 (0) 27 39 40 33 0  
INFO@THERMACUT.DE

WWW.THERMACUT.COM  
TEL.: 1-603-542-6715  
CUSTOMERSERVICE@THERMACUT.COM

THERMACUT®, FHT-EX® AND EX-TRAFIRE® ARE REGISTERED TRADEMARKS OF THERMACUT, K.S. AND MAY BE REGISTERED IN CZECH REPUBLIC AND/OR OTHER COUNTRIES. ALL OTHER TRADEMARKS ARE PROPERTIES OF THEIR RESPECTIVE OWNERS. THERMACUT IS NO WAY AFFILIATED WITH Hypertherm®. MOST THERMACUT PARTS ARE MADE FOR OR BY AN IBG COMPANY. PARTS INDICATED WITH A OEM ARE ORIGINAL PARTS MANUFACTURED BY THE ABOVE NAMED MANUFACTURER AND ARE BEING RESOLD BY THERMACUT. THERMACUT RESERVES THE RIGHT TO SUBSTITUTE OEM PARTS IN PLACE OF THERMACUT PARTS. VALID FROM FEBRUARY 2018 • PREVIOUS VERSION IS NO LONGER VALID. • © COPYRIGHT 2018 BY THERMACUT® CZECH REPUBLIC. ALL RIGHTS RESERVED.

# REPLACEMENT PARTS SUITABLE FOR Hypertherm®

## HPR®130/HPR®260 Torches and Cable leads

Item	Part No.	Ref. No.	Description	Std. Pkg.	Item	Part No.	Ref. No.	Description	Std. Pkg.
1., 3.	T-11137	220162	Torch Q. D. Orig. design (incl. item 3 – 4 pcs; included 2 pcs cooling tube 220340-UR)	1		KT-1106	128785	Cable Leads 15m (50ft)	1
1a.	N-10096	1-028B	O-Ring	1		KT-1269	K.HPR130.18M.K	Cable Leads 18m (59ft)	1
1b.	N-10054	1-008S	O-Ring	1		KT-1150	128988	Cable Leads 20m (65ft)	1
1c.	N-18157	N-18157	Conical Sealing	1		KT-1270	K.HPR130.21M.K	Cable Leads 21m (69ft)	1
2.	T-11138	220163	Receptacle Q. D. Original design	1	!!!	KT-1245	DEMO_HPR130	Torch + cable leads 0,8m, for exhibition only, inoperative!	1
2a.	N-18108	O-KR-45x3,5B	O-Ring	1	1,2,3,4,5	KT-1331	K.HPR130.7,5M	Torch with Leads 7,5m (25ft)	1
3.	T-11769	T-11769	Connector Tube HPR® with O-Rings	1		KT-1421	K.HPR130.20M	Torch with Leads 20m (65ft)	1
3a.	N-10055	1-009S	O-Ring	1					
4.	T-10492	220232	Mounting Tube	1	1a, 1b, 1c, 3, 3a	T-11864	128879	Set of spare parts for 220162, contains items 3 (4 pcs), 3a (8 pcs), 1a (2 pcs), 1b (1 pc), 1c (1 pc), 2a (1 pc), cooling tube 220340-UR, silicon lubricant T-0994	1
5.	KT-1108	128986	Cable Leads 2m (6ft)	1					
	KT-1397	128935	Cable Leads 3m (10ft)	1					
	KT-1117	128934	Cable Leads 4,5m (15ft)	1					
	KT-1052	128784	Cable Leads 7,5m (25ft)	1	##6.	T-11409##	220573	Receptacle Q.D., Bevel	1
	KT-1126	128987	Cable Leads 10m (35ft)	1	##6a.	T-11410##	220546	Torch mounting sleeve, Bevel	1

## RECEPTACLE Q.D., BEVEL POS. 8 IS NOT COMPATIBLE WITH STANDARD CABLE LEADS POS. 7

!!! DEMO IS INOPERATIVE, FOR EXHIBITION PURPOSES ONLY!

Q.D. QUICK DISCONNECT

ALL PARTS ARE WITH O-RINGS

**Last update of this page: 15/02/2018. See Revision history for details.**

**THERMACUT®**  
THE CUTTING COMPANY

WWW.THERMACUT.CZ  
TEL.: +420 556 423 418  
SALES@THERMACUT.CZ

WWW.THERMACUT.DE  
TEL.: +49 (0) 27 39 40 33 0  
INFO@THERMACUT.DE

WWW.THERMACUT.COM  
TEL.: 1-603-542-6715  
CUSTOMERSERVICE@THERMACUT.COM

THERMACUT®, FHT-EX® AND EX-TRAFIRE® ARE REGISTERED TRADEMARKS OF THERMACUT, K.S. AND MAY BE REGISTERED IN CZECH REPUBLIC AND/OR OTHER COUNTRIES. ALL OTHER TRADEMARKS ARE PROPERTIES OF THEIR RESPECTIVE OWNERS. THERMACUT IS NO WAY AFFILIATED WITH Hypertherm®. MOST THERMACUT PARTS ARE MADE FOR OR BY AN IBG COMPANY. PARTS INDICATED WITH A OEM ARE ORIGINAL PARTS MANUFACTURED BY THE ABOVE NAMED MANUFACTURER AND ARE BEING RESOLD BY THERMACUT. THERMACUT RESERVES THE RIGHT TO SUBSTITUTE OEM PARTS IN PLACE OF THERMACUT PARTS. VALID FROM FEBRUARY 2018 • PREVIOUS VERSION IS NO LONGER VALID. • © COPYRIGHT 2018 BY THERMACUT® CZECH REPUBLIC. ALL RIGHTS RESERVED.